

The F & G Cantilever Bases *2 year warranty*

(model F & G are both shown)



The "F" series cantilever style base utilizes 2" square heavy wall 14 gauge construction with angle support. Black painted finish.

Sizes Available

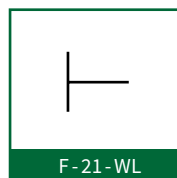

Top Capacity: 24" - 30"
(16 lbs)

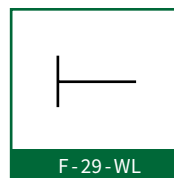

Top Capacity: 36" - 48"
(18 lbs)

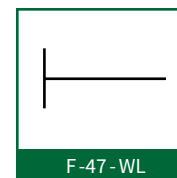

Top Capacity: 54" - 60"
(25 lbs)

**We recommend wall blocking at 12" and 27" to secure the cantilever.*

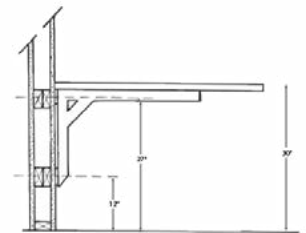

F-29-WL

The "G" series cantilever, utilizes 2" square heavy wall construction and includes table mounting bracket. Black painted finish.

Sizes Available

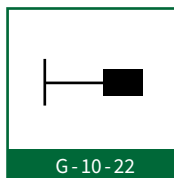

Top Capacity: 24" - 30"
(10 lbs)

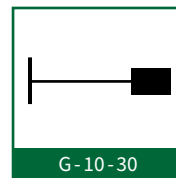

Top Capacity: 36" - 54"
(12 lbs)

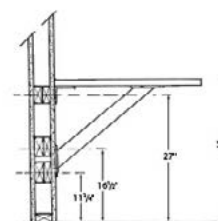

G-10-22

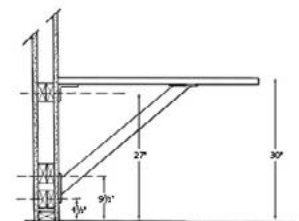

G-10-30

Questions: If you have any questions, feel free to visit our website for more info or contact our office.